

# 135A - 135 DEGREE CLIP-ON CABINET HINGE

Enabling full access to the stored content within



## 135 DEGREE CABINET HINGE

### TECHNICAL SPECIFICATIONS

Open Angle	: 135°	Base Adjustment	: -2.5mm/ +2.5mm
Range of door thickness	: 15-20mm	Diagonal Adjustment	: -9.5mm/ +9.5mm
Diameter of hinge cup	: 35mm	Quality Standard	: Grade 2 of EN15570
Depth of hinge cup	: 11.5mm	Hinge Cup Material	: Cold-rolled steel
Depth Adjustment	: -3.0mm/ +3.0mm	Hinge Plate Material	: Cold-rolled steel

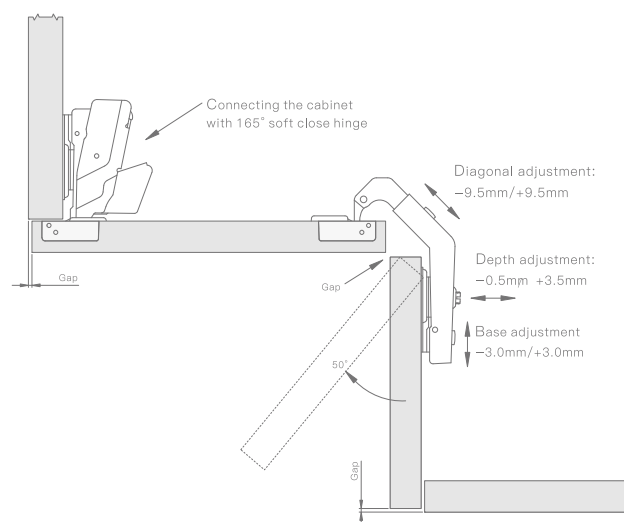

Drilling size: 48mm

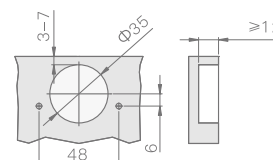

Item Code

Descriptions

11.K135A

135° 5/8" Clip-on Hinge, Mounting Plate 4 Hole For Wooden Door